

Société de Promotion Immobilière Pour la Vente et la Location
PROJET DE CONSTRUCTION D'UN CENTRE DE VIE - MGHIRA III

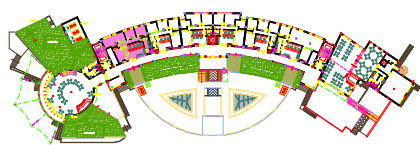
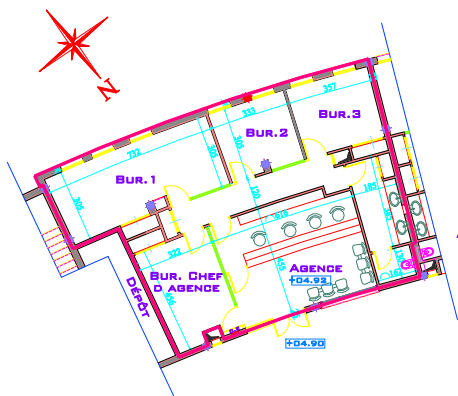

AGENCE 1

Niveau:	1er Etage
Surface Utile:	105.40 m ²
Surface HD :	117.67 m ²
Surface Commune:	38.73 m ²
Surf Vendable:	156.40 m ²